

ATTENUATION VALUE	"A"
0 - 12.5	.84
13 - 30	.97

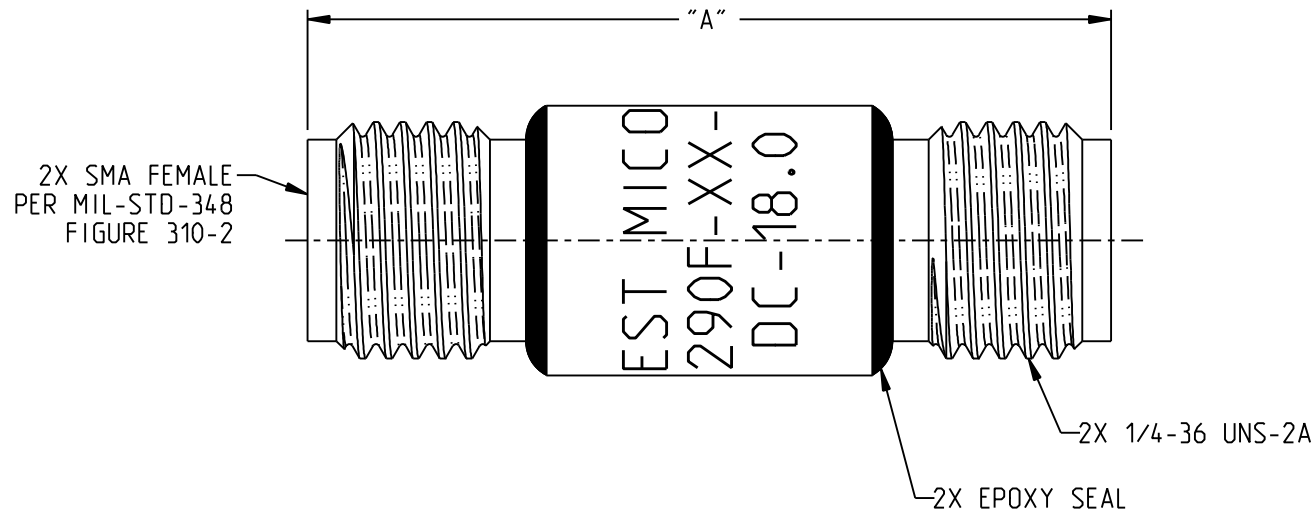
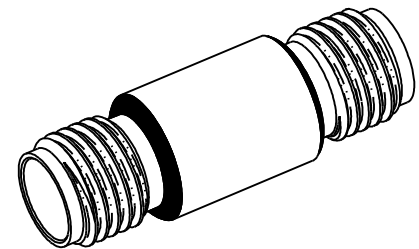

NOTES: UNLESS OTHERWISE SPECIFIED.

1. MATERIAL & FINISH:

- 1.1 HOUSING: PASSIVATED STAINLESS STEEL
- 1.2 DIELECTRIC: PTFE (TEFLON)
- 1.3 CENTER CONTACT: GOLD PLATED BERYLLIUM COPPER

2. SPECIFICATIONS:

- 2.1 FREQUENCY RANGE: DC - 18.0 GHz
- 2.2 ATTENUATION ACCURACY:
  - 2.2.1 0 dB = +0.3/-0 dB
  - 2.2.2 0.5 - 6 dB = ±0.3 dB
  - 2.2.3 6.5 - 20 dB = ±0.5 dB
  - 2.2.4 20.5 - 30 dB = ±1.0 dB
- 2.3 VSWR (MAX): 1.07 + .015F (GHz)
- 2.4 INPUT POWER (MAX):

AVERAGE: 2 WATTS AT 25°C DERATED LINEARLY TO 0.5 WATTS AT 125°C

PEAK: 200 WATTS FOR A DUTY CYCLE OF 5 X 10<sup>-4</sup>, MAX PULSE DURATION OF 5 MICROSECONDS.

- 2.5 OPERATING TEMP. RANGE: -65°C TO 125°C

<p>This PROPRIETARY Document is property of Cinch Connectivity Solutions. It is confidential in nature, non-transferable, and issued with the clear understanding that it is not traced or copied without permission and is returned upon demand.</p> <p>INTERPRET DRAWING IN ACCORDANCE WITH ASME Y14.5-2009.</p>		<b>MIDWEST MICROWAVE</b>	
	RoHS2 <input checked="" type="checkbox"/> 2011/65/EU	Title: ATTENUATOR 0-30 dB	
	UNLESS OTHERWISE SPECIFIED UNITS: INCH	Model No.: ATT-290F-XX-SMA-02	
	ANGLES ±2°	Size A	DO NOT SCALE DRAWING